



KEY

	CATEGORY A
	CATEGORY B
	CATEGORY C
	CATEGORY U
	RPA (RADIUS)

BS5837 (2012) TREE SURVEY NOTES  
1. In accordance with BS5837(2012) this drawing is a colour coded schedule and should not be read in black and white  
2. If received electronically it is the recipients responsibility to print this drawing to correct scale. Only written dimensions should be used where not printed to scale.  
3. This drawing should be read in conjunction with all other relevant drawings and specifications  
4. Marcus Foster Arboricultural Design & Consultancy accepts no liability for any use of this document other than by its client and only for the purposes for which it was prepared and provided

Revisions			
Rev.	Date		Checked
/ A	14.09.2017 18.06.2018	ISSUED FOR INFORMATION ISSUED FOR INFORMATION	MF MF
JOB TITLE			
KENSINGTON FORUM			
DWG TITLE			
EXISTING TREE SURVEY			
SCALE		DATE	
1:250@A1		SEPT 2017	
JOB NO		DWG NO.	
173		T001	





KEY

	CATEGORY A
	CATEGORY B
	CATEGORY C
	CATEGORY U
	RPA (RADIUS)

**BS5837 (2012) TREE SURVEY NOTES**  
1. In accordance with BS5837(2012) this drawing is a colour coded schedule and should not be read in black and white  
2. If received electronically it is the recipients responsibility to print this drawing to correct scale. Only written dimensions should be used where not printed to scale.  
3. This drawing should be read in conjunction with all other relevant drawings and specifications  
4. Marcus Foster Arboricultural Design & Consultancy accepts no liability for any use of this document other than by its client and only for the purposes for which it was prepared and provided

Revisions			
Rev.	Date		Checked
/	14.09.2017	ISSUED FOR INFORMATION	MF
A	28.09.2017	REVISED & ISSUED FOR INFORMATION	MF
B	23.04.2018	REVISED & ISSUED FOR INFORMATION	MF
C	18.06.2018	REVISED & ISSUED FOR INFORMATION	MF

JOB TITLE  
KENSINGTON FORUM

DWG TITLE  
PROPOSED TREE SURVEY: Ground

SCALE  
1:250@A1

DATE  
SEPT 2017

JOB NO  
173

DWG NO.  
T002

T: 0781 2024070  
marcus@mfdesignconsultancy.com  
www.mfdesignconsultancy.com

**Marcus Foster**  
TREE CONSULTANCY



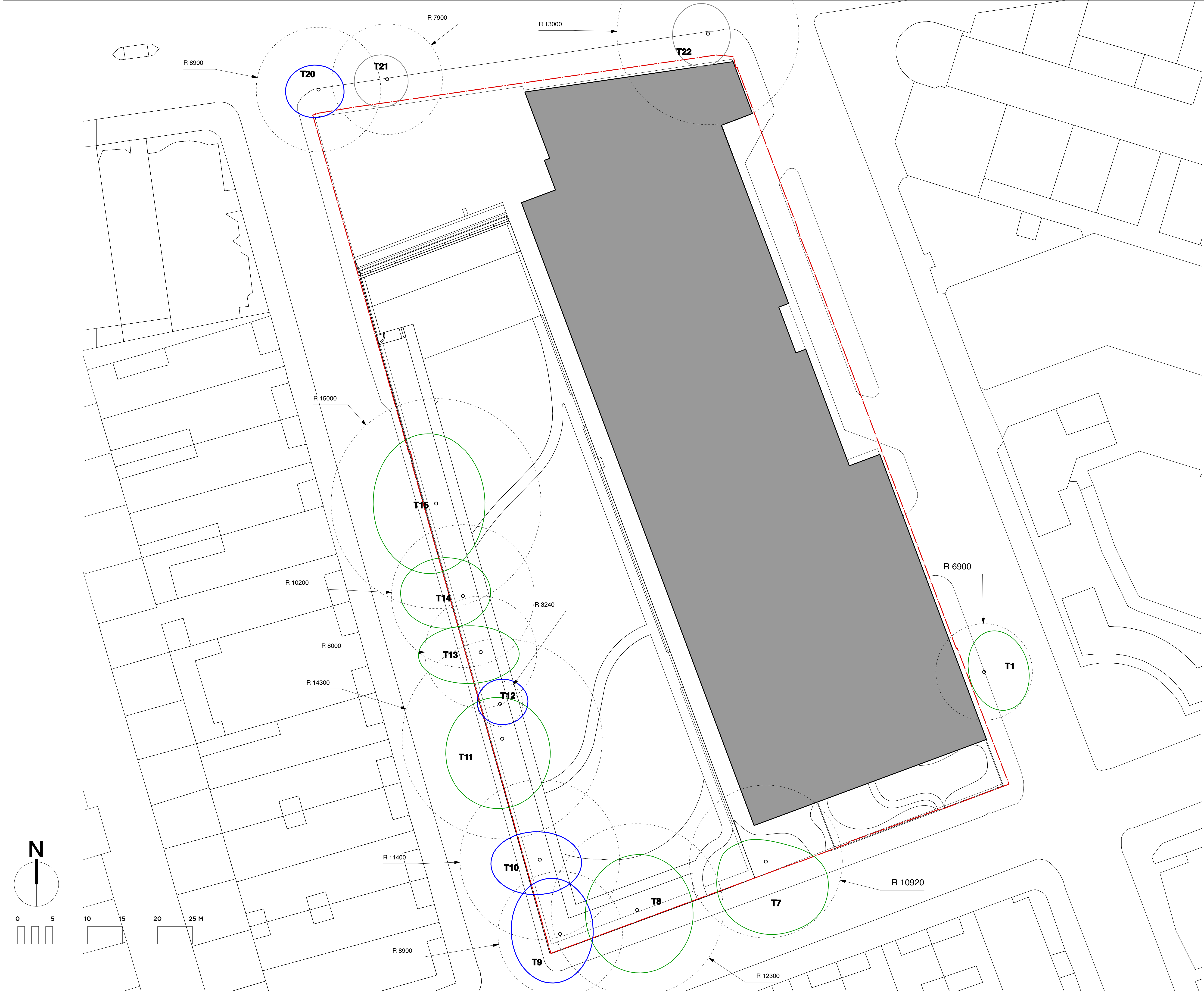

KEY

	CATEGORY A
	CATEGORY B
	CATEGORY C
	CATEGORY U
	RPA (RADIUS)

**BS5837 (2012) TREE SURVEY NOTES**  
1. In accordance with BS5837(2012) this drawing is a colour coded schedule and should not be read in black and white  
2. If received electronically it is the recipients responsibility to print this drawing to correct scale. Only written dimensions should be used where not printed to scale.  
3. This drawing should be read in conjunction with all other relevant drawings and specifications  
4. Marcus Foster Arboricultural Design & Consultancy accepts no liability for any use of this document other than by its client and only for the purposes for which it was prepared and provided

Revisions			
Rev.	Date		Checked
/	14.09.2017	ISSUED FOR INFORMATION REVISED & ISSUED FOR INFORMATION REVISED & ISSUED FOR INFORMATION REVISED & ISSUED FOR INFORMATION	MF
A	28.09.2017		MF
B	23.04.2018		MF
C	18.06.2018		MF

JOB TITLE	
KENSINGTON FORUM	
DWG TITLE	
PROPOSED TREE SURVEY: GROUND WITH RPA	
SCALE	
1:250@A1	
DATE	
SEPT 2017	
JOB NO	
173	
DWG NO.	
T003	



T: 0781 2024070  
marcus@mfdesignconsultancy.com  
www.mfdesignconsultancy.com

**Marcus Foster**  
TREE CONSULTANCY



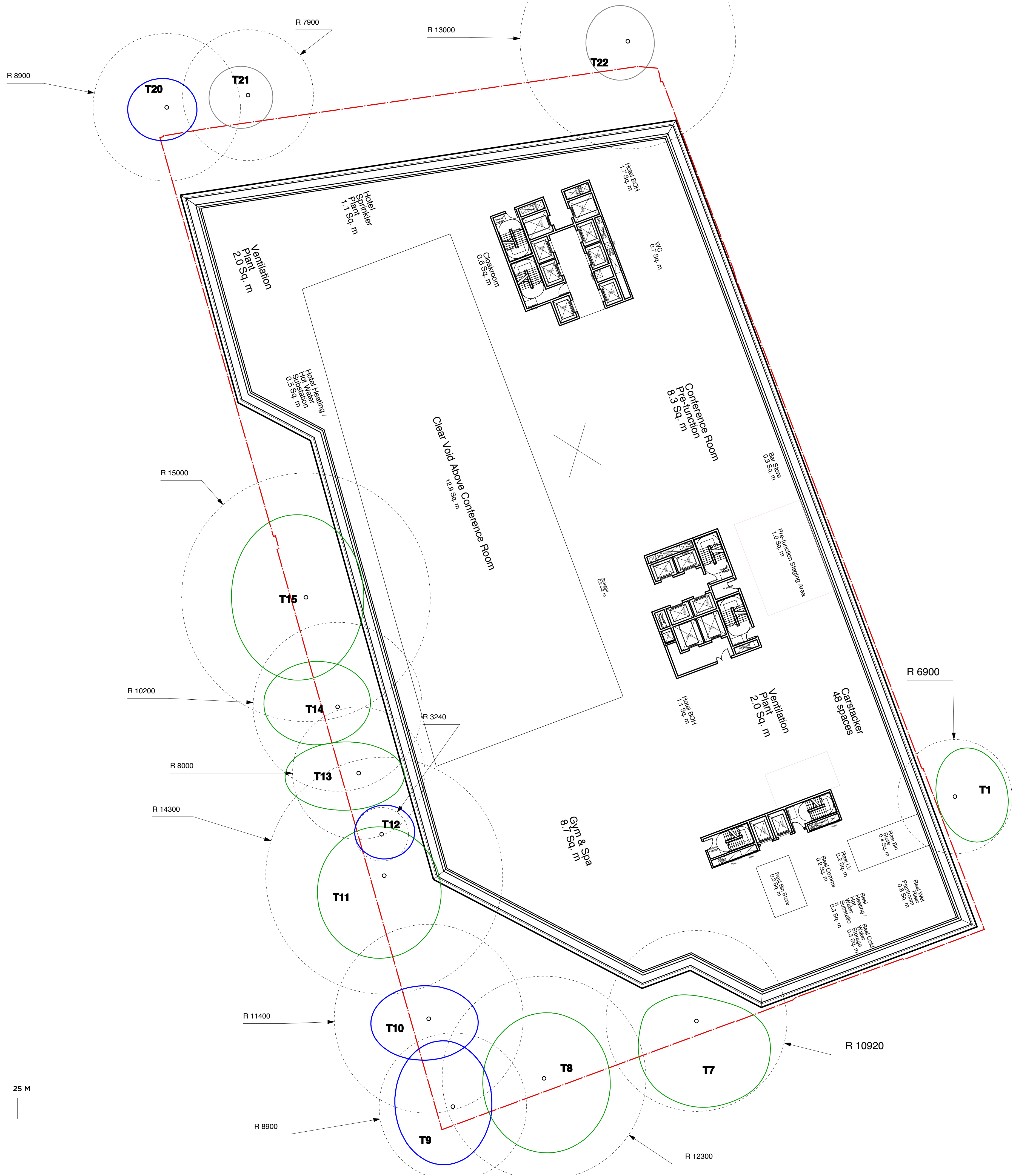

KEY	
	CATEGORY A
	CATEGORY B
	CATEGORY C
	CATEGORY U
	RPA (RADIUS)

BS5837 (2012) TREE SURVEY NOTES  
1. In accordance with BS5837(2012) this drawing is a colour coded schedule and should not be read in black and white  
2. If received electronically it is the recipients responsibility to print this drawing to correct scale. Only written dimensions should be used where not printed to scale.  
3. This drawing should be read in conjunction with all other relevant drawings and specifications  
4. Marcus Foster Arboricultural Design & Consultancy accepts no liability for any use of this document other than by its client and only for the purposes for which it was prepared and provided

Revisions		
Rev.	Date	Checked
/	14.09.2017	MF
A	28.09.2017	MF
B	23.04.2018	MF
C	18.06.2018	MF

JOB TITLE	
KENSINGTON FORUM	
DWG TITLE	
PROPOSED TREE SURVEY: BASEMENT 1 WITH RPA	
SCALE	DATE
1:250@A1	SEPT 2017
JOB NO	DWG NO.
173	T004



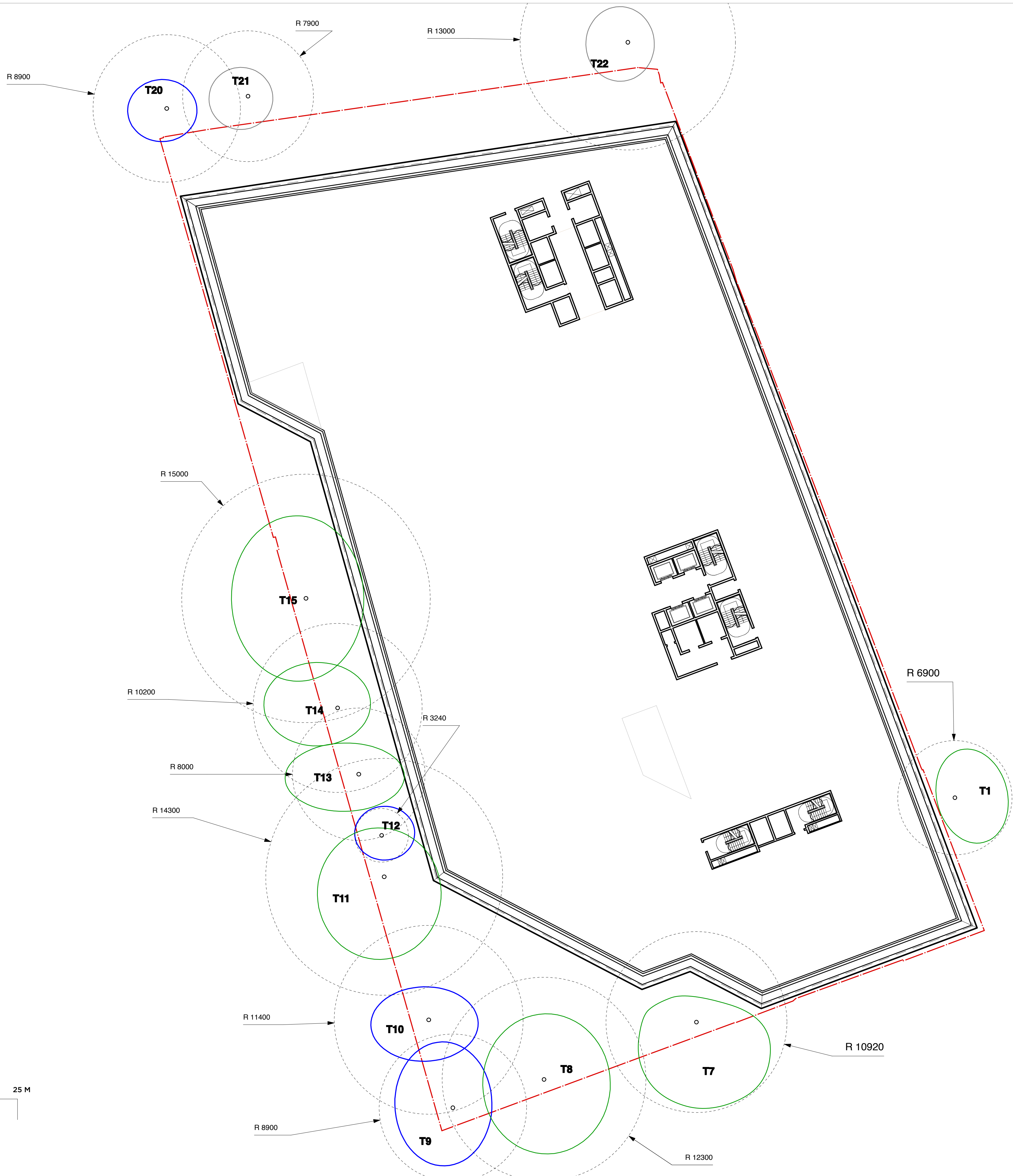

KEY	
	CATEGORY A
	CATEGORY B
	CATEGORY C
	CATEGORY U
	RPA (RADIUS)

BS5837 (2012) TREE SURVEY NOTES  
1. In accordance with BS5837(2012) this drawing is a colour coded schedule and should not be read in black and white  
2. If received electronically it is the recipients responsibility to print this drawing to correct scale. Only written dimensions should be used where not printed to scale.  
3. This drawing should be read in conjunction with all other relevant drawings and specifications  
4. Marcus Foster Arboricultural Design & Consultancy accepts no liability for any use of this document other than by its client and only for the purposes for which it was prepared and provided

Revisions			
Rev.	Date		Checked
/	14.09.2017	ISSUED FOR INFORMATION	MF
A	28.09.2017	REVISED & ISSUED FOR INFORMATION	MF
B	23.04.2018	REVISED & ISSUED FOR INFORMATION	MF
B	18.06.2018	REVISED & ISSUED FOR INFORMATION	MF

JOB TITLE	
KENSINGTON FORUM	
DWG TITLE	
PROPOSED TREE SURVEY: BASEMENT 2 WITH RPA	
SCALE	DATE
1:250@A1	SEPT 2017
JOB NO	DWG NO.
173	T005

KEY

	CATEGORY A
	CATEGORY B
	CATEGORY C
	CATEGORY U
	RPA (RADIUS)

Retention of trees T20 & T21 is proposed within scheme. Main stems are located outside of proposed development site but RPA to south of trees sited within area of potential associated construction site activities and soft and hard landscape works. Protection for

T20: 8.88m radius of main stem / 247.7m<sup>2</sup>  
T21: 7.92m radius of main stem / 197.1m<sup>2</sup>

as outlined within AMS to provide protection of southern root plate and overhanging canopy for each tree during the development process

PROPOSED  
GROUND  
FLOOR

EXISTING  
GROUND  
FLOOR

PROPOSED  
BASEMENT

Removal of trees T16-T19 which are sited above pre-existing structure are required for demolition of existing structure and re-implementation of Ashburn Garden Square. Amenity value will be replaced and improved for the long term

Retention and protection of trees T13-T15 required with close adherence to AMS where tree root plate and canopy encroaches within the development to the east of the tree and surrounding southern and northern root plate where areas will require re-landscaping. Protection distances of

T13 - 8.04m radius of main stem / 203.1 m<sup>2</sup> area  
T14 - 10.02m radius of main stem / 326.9 m<sup>2</sup> area  
T15 - 15.0m radius of main stem / 706.9 m<sup>2</sup> area

as deemed appropriate for asymmetric root morphology where outside of existing and proposed basement footprint; existing ground floor and basement building lines encroach within RPA of retained tree

Retention and protection of tree T11 required with close adherence to AMS where tree root plate and canopy encroaches within the development to the east of the tree and surrounding southern and northern root plate where areas will require re-landscaping. Protection distances of 14.28m radius of main stem / 640.6 m<sup>2</sup> area as deemed appropriate for asymmetric root morphology where outside of existing and proposed basement footprint; existing and proposed basement building line encroach within RPA of retained tree

Removal of trees T2 - T6 required for implementation of proposed development and regeneration of Ashburn Square Gardens in accordance with landscape scheme as proposed by Exterior Architecture. The improvement of landscape for this garden square within a soft and hard landscape scheme incorporating tree and shrub plantings will provide continued and enhanced amenity value for the long term

Tree T12, an early mature Holly tree (understorey) which should be removed or replaced within the scheme as deemed appropriate in context of the wider development of the site and Ashburn Square Gardens

Retention of tree T10 outside of proposed development footprint but within area of associated construction site activities and soft and hard landscape works. Protection for 9.24m of main stem / 268.2m<sup>2</sup> as outlined within AMS to provide protection of root plate and overhanging canopy for development process

Retention of tree T9 outside of proposed development footprint but within area of associated construction site activities and soft and hard landscape works. Protection for 9.24m of main stem / 268.2m<sup>2</sup> as outlined within AMS to provide protection of root plate and overhanging canopy for development process

EXISTING BASEMENT (DASHED)

Retention of tree T22 is proposed within scheme. Protection required with close adherence to AMS where tree root plate and canopy encroaches within the development to the south of the tree. Protection distance of 13.08m radius from main stem / 537.5m<sup>2</sup> area as deemed appropriate for root morphology further to investigative works are required to determine extent and nature over proposed development line; proposed ground floor and basement building lines encroach within RPA of retained tree and southern upper canopy where crown is at latter stages of cyclical pruning programme

Due to the significant nature of the development, incorporating the regeneration of Ashburn Garden Square to which this public highway links (through placement of T20 and T21) combined with the fair condition only of the tree (with large structural defect) and consequently limited lifespan, it is recommended that discussion is undertaken with the Local Authority regarding the long term public highway and landscape strategy for the section of Cromwell Road between Ashburn Gardens & Ashburn Place

Retention and protection of tree T1 required with close adherence to AMS where tree root plate and canopy encroaches within the development to the west of the tree. Protection distance of 152.2m area / 6.96m radius of main stem as deemed appropriate for likely asymmetric root morphology due to existing site features; proposed ground floor and basement building lines encroach within RPA of retained tree - these excavations currently exist in the form of existing basement to pavement / public highway line. Tree protection required for

- Protection of canopy including remedial tree pruning works to provide a more balanced and compact canopy for the western canopy tree pruning works required to accommodate building line; balancing tree works required for the remainder of crown to retain the tree for the long term in a reduced state with even flowing canopy / pollard outline
- Protection of root plate where proposed ground floor layout encroaches within RPA (where within basement footprint which currently exists)

RPA WHERE WITHIN EXISTING & PROPOSED BASEMENT FOOTPRINT

Retention and protection of tree T7 required with close adherence to AMS where tree root plate and canopy encroaches within the development to the north of the tree and surrounding western and eastern root plate where areas will require re-landscaping. Protection distances of 10.9m radius of main stem / 374.6 m<sup>2</sup> area as deemed appropriate for asymmetric root morphology where outside of existing and proposed basement footprint; existing and proposed basement building line encroach within RPA of retained tree. Tree protection required for

- Protection of canopy including remedial tree pruning works to provide a more balanced and compact canopy to the north / north east which should remain with an even and flowing canopy outline - to provide clearance from development process and for the long term
- Protection of root plate where proposed ground floor layout encroaches within RPA (where within basement footprint which currently exists)

Retention of tree T8 required - Main stem and RPA located outside of proposed development footprint but within area of associated construction site activities and soft and hard landscape works. Protection for 12.36m of main stem / 479.9m<sup>2</sup> as outlined within AMS to provide protection of root plate and overhanging canopy for development process

BS5837 (2012) TREE SURVEY NOTES

- In accordance with BS5837(2012) this drawing is a colour coded schedule and should not be read in black and white
- If received electronically it is the recipient's responsibility to print this drawing to correct scale. Only written dimensions should be used where not printed to scale.
- This drawing should be read in conjunction with all other relevant drawings and specifications
- Marcus Foster Arboricultural Design & Consultancy accepts no liability for any use of this document other than by its client and only for the purposes for which it was prepared and provided

Revisions			
Rev.	Date		Checked
A	26.09.2017	ISSUED FOR INFORMATION	MF
B	23.04.2018	REVISED & ISSUED FOR INFORMATION	MF
C	16.06.2018	REVISED & ISSUED FOR INFORMATION	MF

JOB TITLE		KENSINGTON FORUM	
DWG TITLE		TREE CONSTRAINTS PLAN (TCP)	
SCALE	1:250@A1	DATE	SEPT 2017
JOB NO.	173	DWG NO.	T006

T: 0781 2024070  
marcus@mfdesignconsultancy.com  
www.mfdesignconsultancy.com

**Marcus Foster**  
TREE CONSULTANCY

